

Outback Liner Installation Guide

Installing the OUTBACK pool liner is a fairly simple process and is likened to assembling an IKEA kit. Every effort has been made at a manufacturing level to make the project DIY friendly and should take about 2-3 hours.

If you are really unsure after reading this guide, there is a long list of liner installers across Australia we could put you in touch with.

Here are step-by-step instructions for installing the OUTBACK pool liner.

Last Updated 7th October 2023

TOOLS AND MATERIALS YOU'LL NEED

Provided:

1. Pool liner
2. Locking strip
3. Pool skimmer and fittings
4. Pump silicone
5. Light (if applicable)

Required:

1. Utility knife or blade
2. Phillips head screwdriver
3. Vacuum (for cleaning and also removing wrinkles)
4. Garden hose
5. Cloth tape
6. A friend or helper



Optional (Recommended):

1. Sticky Backed Expansion Joint Foam (to cover rivets)
2. Polyethylene or XPE Foam Liner Roll (for insulating)
3. 100mm Spring Clamps (useful as extra hands)

BEFORE YOU START

1. Ensure you have all the equipment and materials at hand
2. Ensure that the pool site is free of sharp objects
3. Although the installation can be completed by one person it is easier with at least two.
4. Do not let pointed objects touch the liner. When walking on the liner, you should work in socks or bare feet.

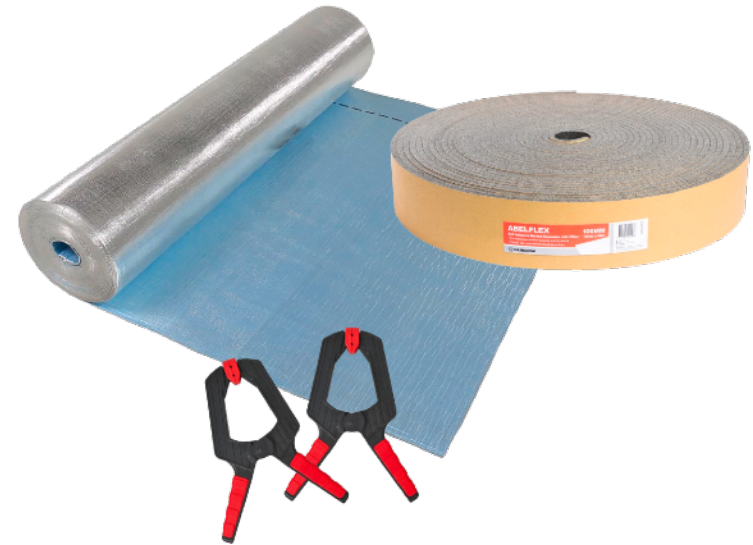

1. INSULATION (RECOMMENDED)

This step is optional but recommended if you want to achieve the best thermal insulation, have a soft experience, and generally improve the overall life of your pool; follow these steps to add insulation.

1. Install the light housing (if applicable - see separate guide).
 2. Unroll the Thermal Foam (insulation) around the pool wall, taping it at intervals to the top black C Channel Clip Strip. No need to tape completely.
 3. At the overlap, keep unrolling the roll by 100mm and rough cut. Remove excess out of the pool.
 4. Using a sharp blade, cut vertically down both layers to create a perfect joint. Secure together vertically with tape.
 5. Using the Sticky Backed Expansion Joint Foam, peel the back and go around the C Channel, locking the insulation in and covering the rivets. Don't cover the C portion of the clip.
 6. Where the fittings are, with your blade carefully cut the insulation around the Fitting Housing and rubber flange.
 7. For added insulation and luxury, it is fine to also put insulation on the floor. Simply lay the foam, trim around the edges and tape to the walls.
- Be careful when installing the liner that it doesn't move.



2. FITTING THE LINER

The OUTBACK liner is what is referred to as a commercial-grade hung liner. If you look at your liner, you will see that it has a black PVC hook welded along the top of the wall. This hook simply clips into the propriety C Channel strip, which has been silicone and riveted just below the top ring. The benefit of hung liners is that they are made to size and extremely quick and easy to install.

1. Install the light housing (if applicable - see separate guide).
2. Install the Bench Seat with Step (if applicable - see below).
3. Ensure the pool floor and walls are completely clean of dust, debris and water.
4. Try not to use any type of knife or sharp object to open the box.
5. With one person inside the pool, carefully remove the liner from the box and pass it into the pool. Try not to have the liner touch the outside ground, where it can pick up dirt or debris.
6. Unroll the liner toward the other end of the pool and gently open it out. The shiny side of the liner is the back and will be placed against the insulation or stainless steel, while the printed or embossed side will hold the water.
7. Find the vertical seam and rotate it to the desired location. At the seam, carefully pop the hook into the C Channel and hold. This is where Spring Clamps come in handy as extra sets of hands.

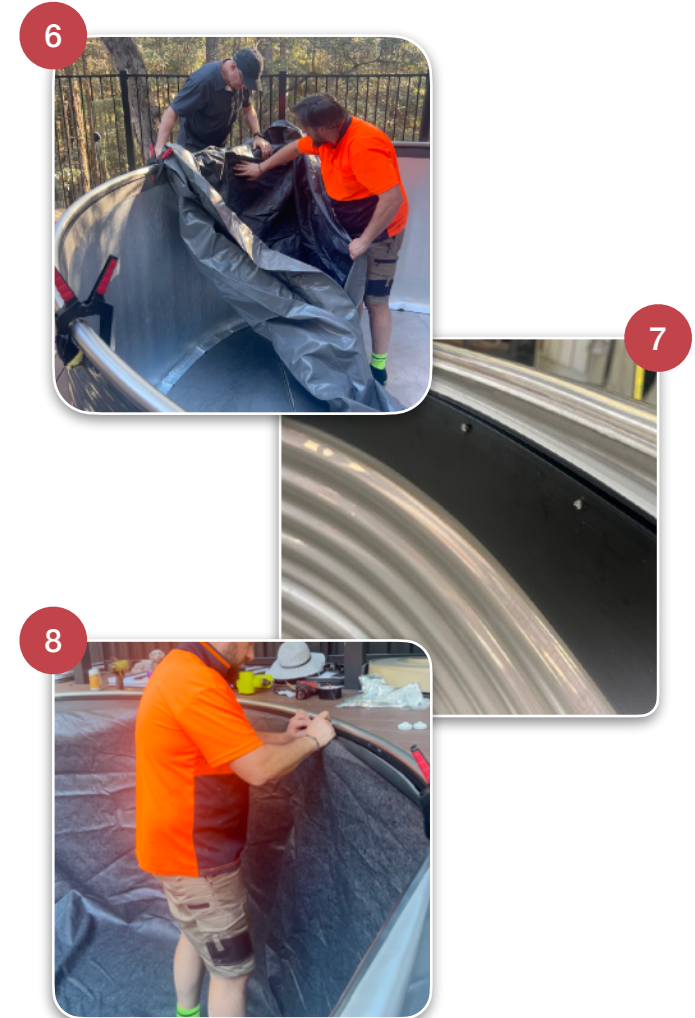

8. Simply work your way around the pool, gently lifting and fitting the liner into the C Channel. Sometimes, the liner may appear tight or loose around the perimeter of the wall. If this happens, stretch or gather the wall to give an even fit.
9. Check that there are no diagonal wrinkles in the wall of the liner as these indicate that the liner is not square with the bottom. This can be adjusted by moving the top of the liner in either a clockwise or anti-clockwise direction inside the C Channel until all wrinkles disappear.
10. Once all floor seams are running straight and the base of the liner is flat with all the large wrinkles removed, it is time to vacuum the liner into place.

3. USING A VACUUM CLEANER

The vacuum is used to suck the liner to the wall. It helps stretch the liner and remove wrinkles.

1. Tape over the plastic Fitting Housings on the outside of the pool if not already plumbed. If plumbed, simply turn the shut-off valves to 'close'.
2. Remove the liner just enough (about 200mm) to slide the vacuum hose down between the wall and the liner. Ensure this opening is at least 1m from any fittings and bench seats.

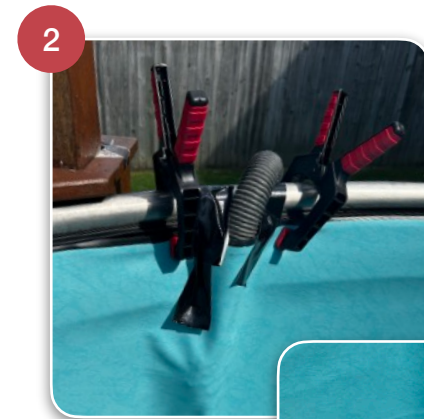

3. Slide the hose of a vacuum cleaner (a Wet & Dry is ideal) through the opening until it is 300mm (12") above the floor. Tape around the hose at the top to create an air seal.
4. Double-check that the liner has no large wrinkles or surplus material, and make sure it is secured firmly.
5. When the vacuum is turned on, the liner will start to suck down to the walls and reveal the corrugations. As it sucks, continually work the wrinkles out toward the edge of the pool. You may have to switch the vacuum off to adjust the liner a few times - this is quite normal.
6. Once you have the liner is vacuumed out and ALL the wrinkles removed, it's time to put the locking strip on. This can also help create a tighter vacuum seal.
7. Now start filling the pool with your garden hose. Make sure any fittings on the hose are removed or protected so they do not damage the liner. Leave the vacuum cleaner running until the pool water is just under (30mm) the bottom first Fitting Housing.
8. Now you can turn the vacuum off. Carefully remove the vacuum hose from the wall of the pool, making sure you get all the tape off and do not allow anything to fall in behind the liner.

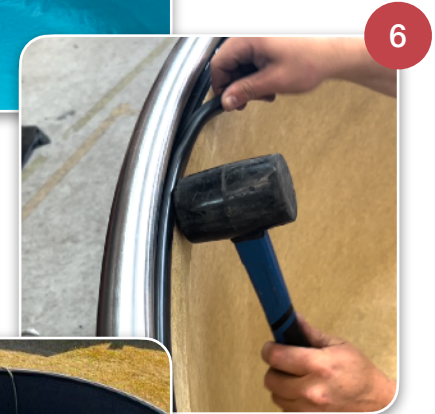

4. INSTALL FITTINGS

This is the step that most people find concerning. Rest assured, it is quite simple if you follow the process. Essentially this involves a clamping ring that is screwed to the Fitting Housings to create a water-tight seal, and then the vinyl is trimmed inside.

Note: for plumbing the equipment to the pool, please refer to the separate plumbing guide. It is not critical that the plumbing is completed before the liner installation. You just won't be able to fill the pool all the way.

1. Start with the bottom fitting (2nd Suction) and work your way up.
2. Using your screwdriver, poke around the Fitting Housing until you find a screw hole. You may need to reference the fitting install guide for reference or use the clamping ring as a size and position guide.
3. Without the clamping ring at this stage, carefully screw a screw through the liner into the found hole.
4. Poke around until you find a second hole approximately opposite from the first, and repeat the process.
5. Remove the screws. These will become your guideholes for later on.
6. In the centre of the Fitting Housing, cut a 50c piece-sized hole in the centre.

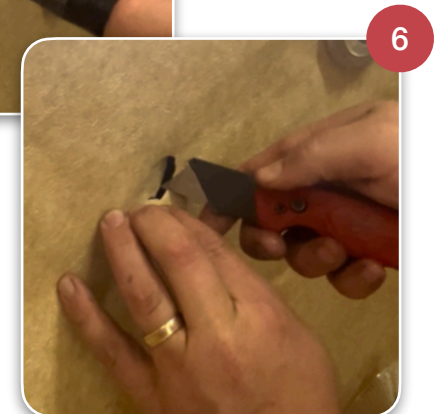
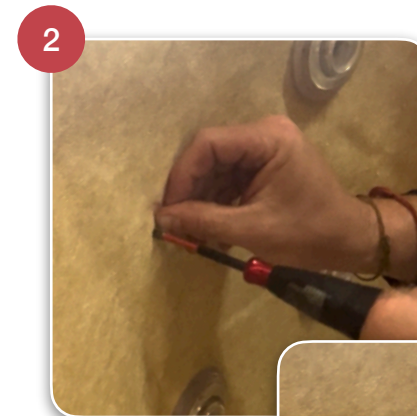

7. Using the pump silicone, place the nozzle between the liner and the housing and pump in all 360-degree directions. You shouldn't need much and you are able to spread it around with your finger. Don't be afraid to pull the liner gently forward to get better access.
8. Place the clamping ring over the two pre-screwed holes and screw tight to 70-80%.
9. Follow a star pattern and complete the process. Note, for the suction fitting only, four screws are required for the clamping ring. The final two will be used to attach the suction cover. See specific instructions for more information.
10. Screw tight to 90-95% in a star pattern. You want to try not to tighten 100% as you run the risk of over-tightening. Plus, the silicon behind the liner adds a second layer of protection.
11. With your blade, cut the remainder of the vinyl inside the clamping ring so that it is flush with the inside of the ring.
12. Feel free to pump more silicon inside the hole and spread it around with your finger for extra peace of mind.
13. Continue the process for the other fittings.

